



DEEP WATER

Wide range of deep water and ultra deep water floats



**PREMIUM
QUALITY** 

Deep water floats for Single Point Mooring Systems, FPSO and FSO

Resinex has developed Deep Water Floats for Single Point Mooring Systems since the early seventies. Previously manufactured in PVC then developed using roto-moulded linear polyethylene, they operate on Calm buoys (Lazy-S or Chinese Lantern configurations) or SALM buoys and now also on FPSO and FSO Systems. Resinex products always comply with OCIMF GMPHOM 2009 rules.

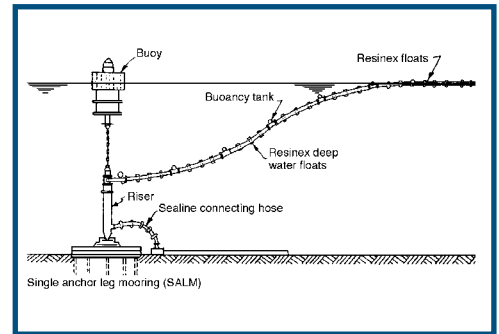
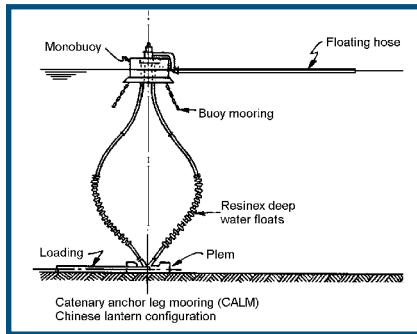
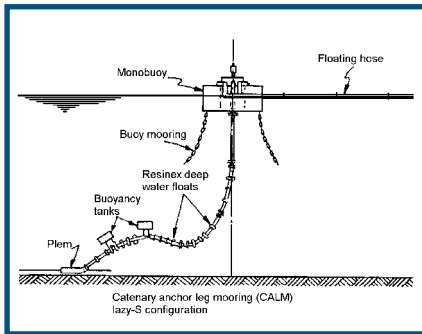

Resinex manufactures three different types of deep water floats for Single Point Mooring Systems and FPSO-FSO Systems with various characteristics and performances. The standard floats cover a range of internal diameter adaptations from 240 mm to 970 mm and a range of net buoyancy from 32 kg to 430 kg.



- 1 **Hinged type:** high assembling angle; high adaptation at oil pumping pressure; wide range of diameters and net buoyancy.
- 2 **Grooved type:** super strong-heavy duty performance, simple metallic part; high buoyancy.
- 3 **Bolted type:** high strength; high hydrodynamicity; simple metallic part.

Hinged type

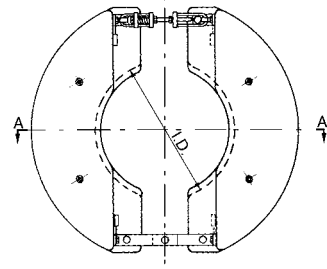
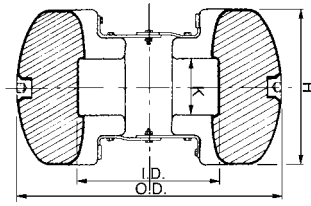

HINGED TYPE	SIZE mm.						WATER DEPTH			
	O.D.	I.D.	H	K	ADJUSTABLE RANGE I.D.		0+40m.		40+80m.	
							Weight Kg.	N.B. Kg.	Weight Kg.	N.B. Kg.
06" BODY	630	250	330	205	240	270	30	32	32	30
06" END - 08" BODY	630	310	330	205	270	340	21	41	26	36
08" END - 10" BODY	700	360	350	205	340	400	25	55	32	48
10" END - 12" BODY	780	420	400	205	410	440	35	76	43	68
12" EXTRA	940	495	550	205	445	520	58	123	70	111
12" END - 16" BODY	940	520	550	205	500	550	61	153	74	140
16" END - 20" BODY	1060	620	540	205	530	660	72	184	84	172
20" EXTRA	1250	800	600	205	785	840	107	273	124	256
20" END - 24" BODY	1160	700	600	205	620	785	89	231	104	216
24" END	1350	876	600	205	876	910	109	291	137	263

Grooved type

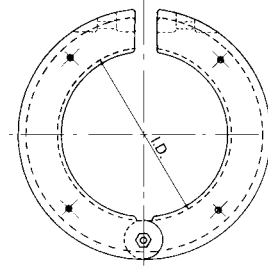
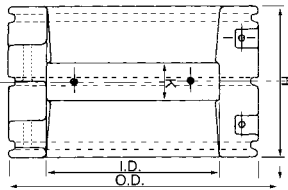

GROOVED TYPE	SIZE mm.						WATER DEPTH			
	O.D.	I.D.	H	K	ADJUSTABLE RANGE I.D.		0+40m.		40+80m.	
							Weight Kg.	N.B. Kg.	Weight Kg.	N.B. Kg.
16" END - 20" BODY	1050	640	550	205	640	697	73	168	90	151
20" END - 24" BODY	1200	740	600	205	700	832	95	267	120	242
24" EXTRA	1370	940	800	205	860	970	138	430	190	376

Bolted type

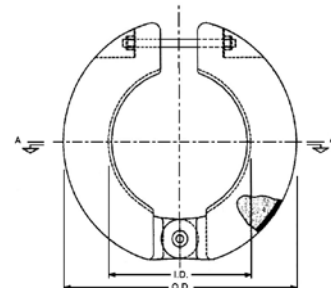
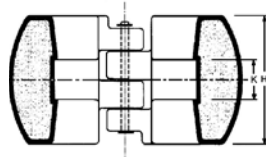

BOLTED TYPE	SIZE mm.						WATER DEPTH			
	O.D.	I.D.	H	K	ADJUSTABLE RANGE I.D.		0+40m.		40+80m.	
							Weight Kg.	N.B. Kg.	Weight Kg.	N.B. Kg.
12" HE - 16" HB	971	530	550	205	450	550	68	140	81	127
24" HE	1390	876	600	205	750	890	122	312	162	272

N.B.: the buoyancy is considered in fresh water. - K: the width collar range can be adapted to every hose float mount from 135 to 205 mm. Water depth: higher depth (till 7.000 mts.) can be reached, weight will be higher, net buoyancy reduced.

Assembling and use

Resinex deep water floats are studied to give the best tightening performance on the float mounts of hoses and on the clamps of risers. Tightening can be obtained directly or through rotomoulded reducers assembled on the float itself. Their particular shape has been studied to allow the higher bending of hoses and risers. The hinged solution adopted by each Resinex type of floats, maximized by the Hinged Type, facilitates all the assembling procedures that can be made also underwater. In case of underwater installation, Resinex supplies plate sinkers to give neutral buoyancy to the float.

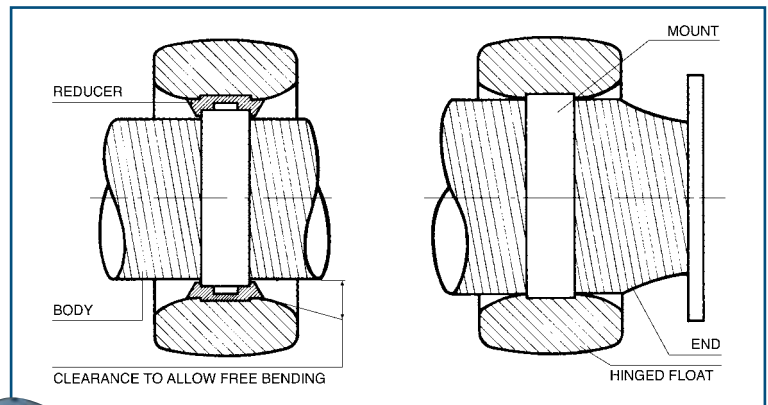

Right: plate sinkers for underwater assembly.



Easy installation around float mount.



Also supports for umbilicals can be easily installed on Resinex Deep Water Floats.



Assembling test of a complete float set for rubber hose in house.



Resinex hinged floats in operation in blue sea.

Ultra Deep water

The continuous development of new technology allows Resinex to utilize the most up-to-date materials and components and thanks to diverse density, buoys are able to function to a depth of 11 thousands metres.

With the innovative Nautex (Glassfoam) and Synt fillings, the ratio between pressure resistance and specific weight can arrive to a high level with a subsequent marked containment of price.

The tests carried out in the big pressure tanks at Resinex Marine Research Centre in Adro vouch the final result.

Besides floats and buoys for ultra deep water usage, the range of Resinex products is enriched by a full range of Riser Floats, Cable Floats and Umbilical Floats.





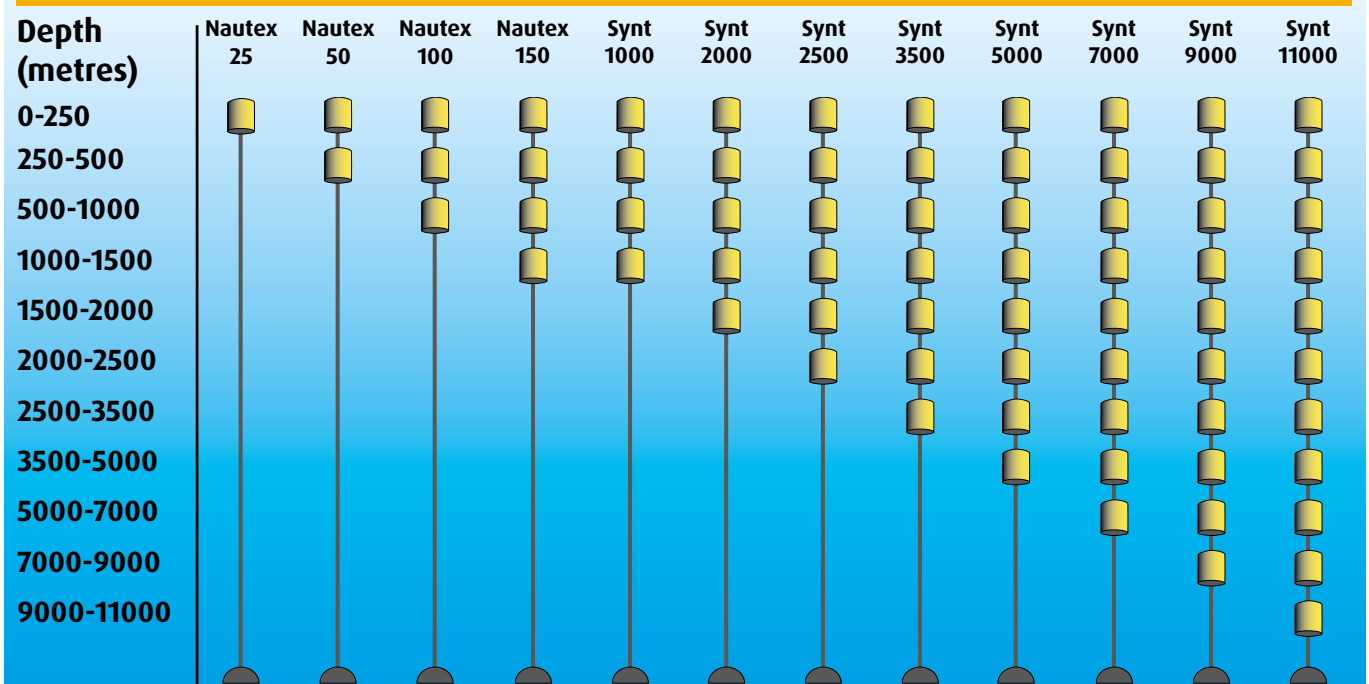













FROM ZERO TO 11000 METRES, RESINEX TECHNOLOGY FOR HIGH DEPTHS



Riser Floats

Resinex produces a full range of Riser Floats and protective Shims to be used during drilling operations. Following the experience of many different projects supplied around the world, the range of Buoyancy Modules used during installation or for permanent use is very wide. Buoyancy elements are always supplied with high performance steel clamps. This type of floats is normally installed between 1000 and 4000 metres water depth.

TYPE	RISER FLOATS: FROM 130 TO 2400 LITRES OF VOLUME			
	Øe (mm)	ØI (mm)	L (mm)	VOLUME (LITRES)
	1450	560-565	1800	2370
	1464	500-550	2000	2130
	1450	250-350	1100	1630
	1404	500-550	2210	1290
	950	50-100	2200	1230
	1500	500-650	750	1090
	1100	200-300	1200	1020
	1000	200-250	1200	830
	1000	200-400	1100	700
	1000	100-200	1000	700
	900	273	580	300
	540	114	800	170
	550	100-200	650	130
	420	144	800	100
	350	60	600	55
	350	60	400	35



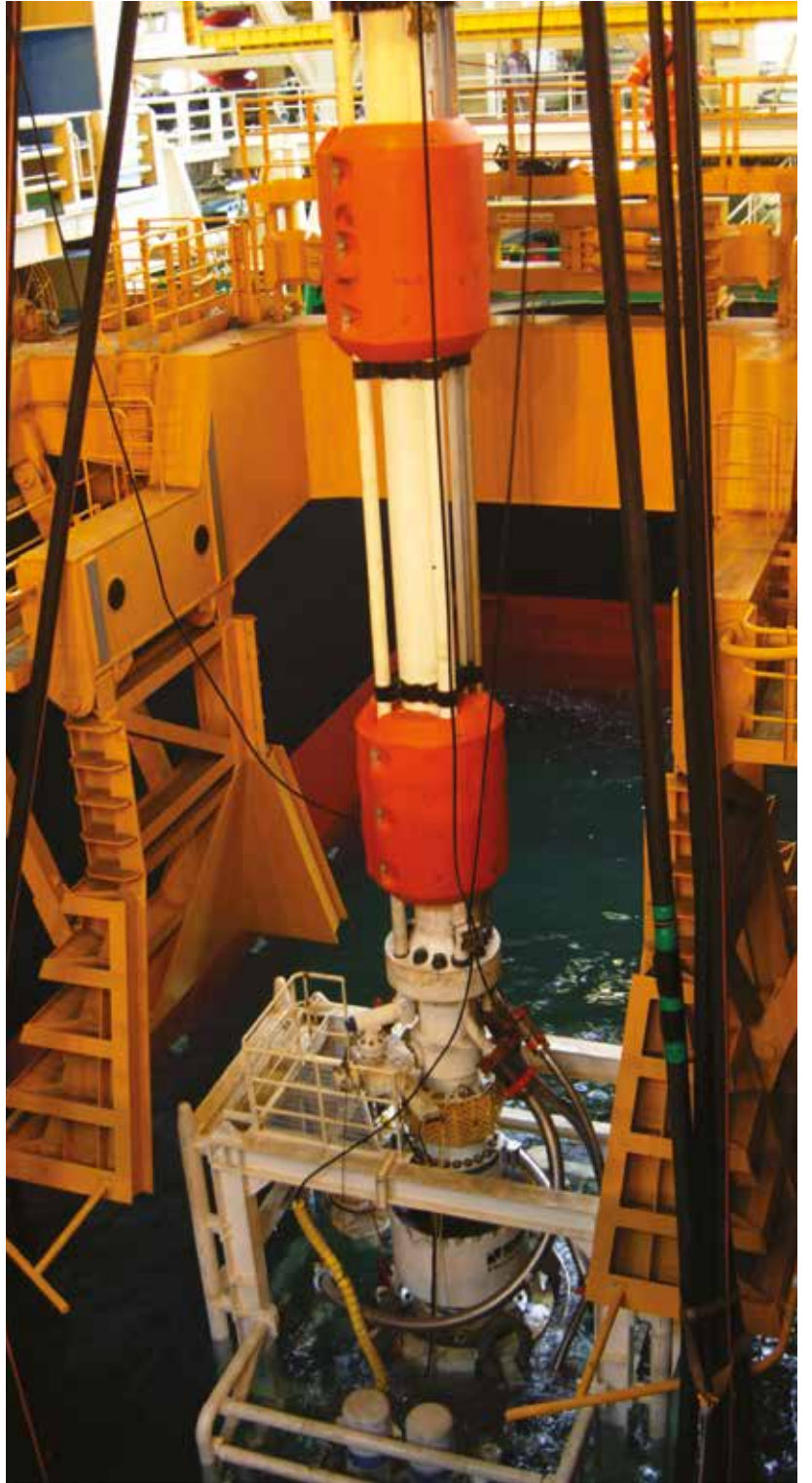







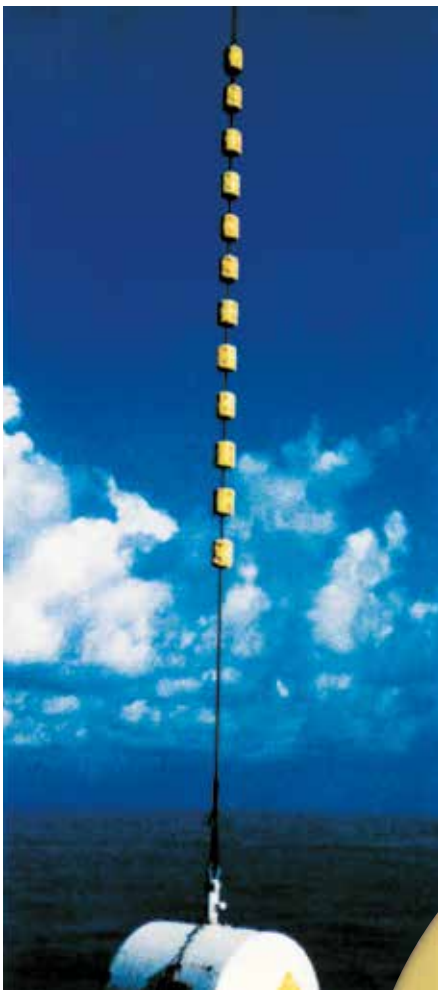

Cable and Umbilical Floats

Not only hoses but also cables, ropes and umbilicals need to be lightened under water. Resinex gives a complete range of floats with reduced diameters to its customers.

The key success factor of this activity is tightening. The floats cannot slip on the cable once assembled.

Resinex has developed particular polyurethane clamps and reducers to maximize the grip on the cable surface. Particular studies have been carried on to give our products the best mixture between loads, weight of materials and tightening forces. Now we can supply different solutions to guarantee the higher tightening force together with the usual high resistance to pressure until a 11,000 metres depth.

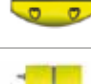
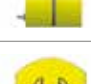

TYPE	MEASURES			UNDERWATER NETT BUOYANCY			
	E Ø (mm)	I Ø (mm)	L (mm)	0-100m	100-600m	600-1,000m	>1,000m
	540	30-114	800	145	100	80	68
	420	30-114	800	82	57	45	39
	400	40	890	60	50	40	35
	450	65-190	550	50	33	25	21
	350	30-60	600	44,5	30,5	23,5	19,5
	420	20-100	600	44	30	23	19
	350	20-105	750	25	20	15	10
	350	30-60	400	28	20	15,5	13,5
	350	20-100	500	28	20,5	16,5	14,5
	150	15-60	300	2,2	1,6	1,3	1,1

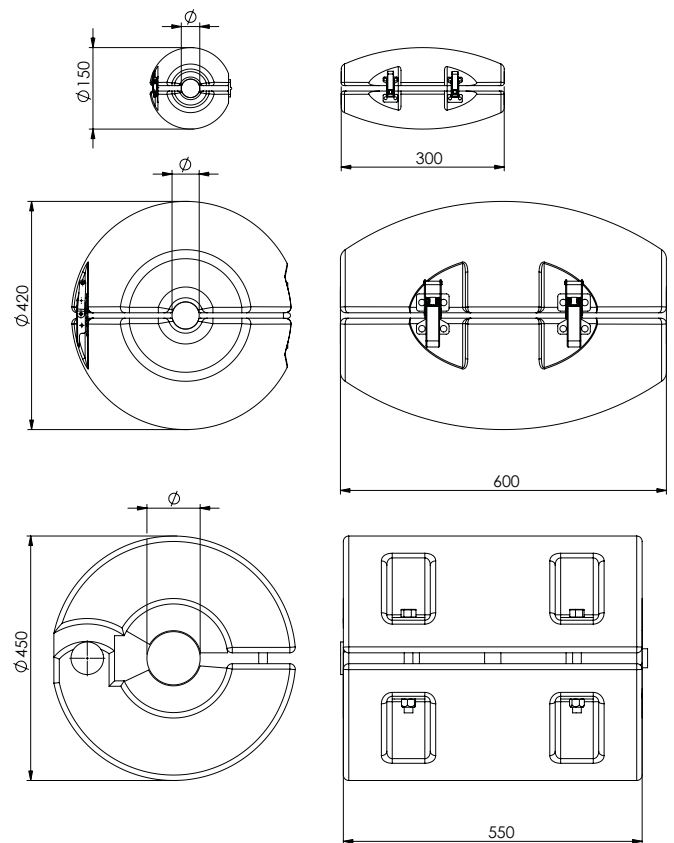

Quality control and tests

Deep waters are not a friendly environment. Being aware of this, Resinex produces deep water floats, monitoring every step of the manufacturing plan. Starting from rotomoulding polyethylene thickness, passing through the quality control of AISI 316 or Titanium metallic part Resinex Quality Assurance Department finally arrives at the strict controls of Nautex (Glassfoam) compounds or Syntactic foam filling.

Resinex, with its products, has always anticipated market needs and invested hefty sums in research thereby always keeping one step ahead of the competition: an example of this is the set of six autoclaves installed in the Adro Marine Research Centre.

There is an autoclave which is able to run pressure resistance tests up to 850 bars, the equivalent of 8500 metres depth under sea level (underneath).

No other similar autoclave exists in continental Europe.

Among the other autoclaves available for Resinex laboratory technicians, there is a giant of 2.1 metres in diameter by 3.5 metres in height which can simulate pressure conditions of up to depths of 500 metres.

In this way our company is once again the vanguard in quality and safety

in its floats, offering an always more advanced service to the customer.

Quality Management of materials and production process is certified by Lloyd's Register Quality Assurance norm ISO 9001:2000.

Exhaustive laboratory tests are carried out on samples taken during the work process. But before being consigned, the floats that come off the production line in Torbiato (Brescia) are first passed through to the nearby Adro Resinex Marine Research Centre which is equipped with the most up-to-date and sophisticated analysis systems. Besides weight and dimension, traction resistance is tested, both of pressure and floatability (net buoyancy) and the data are fed into a computerized system which gives a report of all the characteristics of the piece in question. This is a type of Identity Card which represents an extra guarantee of Resinex quality.

- 1 Traction strength test on hinged floats.
- 2 Weight procedures at electronic scales.
- 3 High pressure tests in the Adro Resinex Marine Research Centre.



» Hydrostatic Pressure Test in 6 pressure tanks till 850 bars



» Buoyancy Test

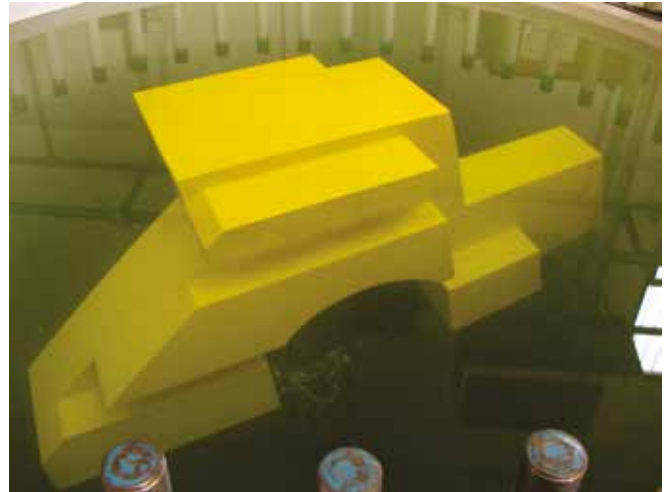

» Infra-red analysis of synt foam filling

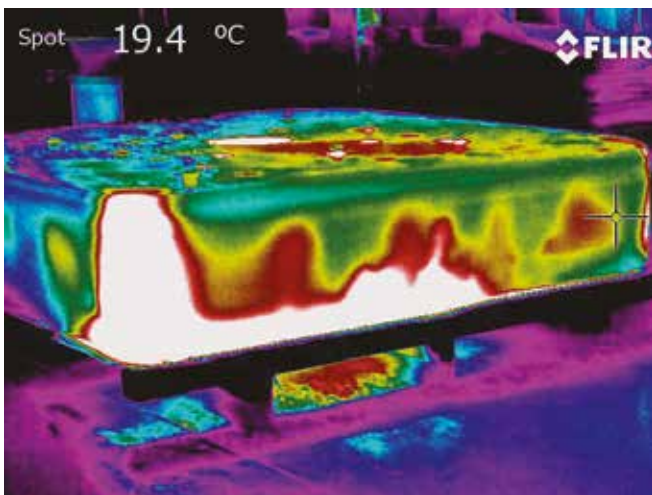

» Fastening Removal Test on Pipe Floats



» Structural Pressure Test on the buoy body



» Impact Test on the buoy body



» Tension Test on float assembly



» Proof Load Test on steel parts



» Crash Test on buoyancy elements



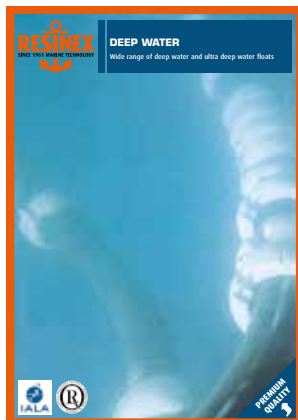

RESINEX

SINCE 1961 MARINE TECHNOLOGY



Resinex Trading S.r.l
 Via Cappuccio, 14
 20123 Milan, Italy
 Ph. +39 02.7201 3463
 Fax +39 02.7210 5548
marketing@resinextrad.com

Torbiato di Adro (BS) - Italy
 Via Artigiani, 15 - 25030
 Ph. +39 030.745 7245
 Fax +39 030.735 6185
production@resinextrad.com
marketing@resinextrad.com

Adro (BS) - Italy
 Via Laveni, 14 - 25030
 Ph. +39 030.745 1194
 Fax +39 030.735 6185
R&D@resinextrad.com

Resinex CoSeMa
 Via Campania, 29
 61122 Pesaro (Italy)
 Ph +39.0721 455337
info@cosema.biz
marketing@resinextrad.com

Resinex Asia - Singapore
 Level 49, One Raffles Quay
 North Tower
 Singapore 048583
 Ph. +65.66225532
sales@resinexasia.com

www.resinextrad.com